

SOIL TEK 

SLD E300

**Excavator
Mounted Drill
Mast**

**Soil Tek
SLD300**

**Volvo
EC300EL**

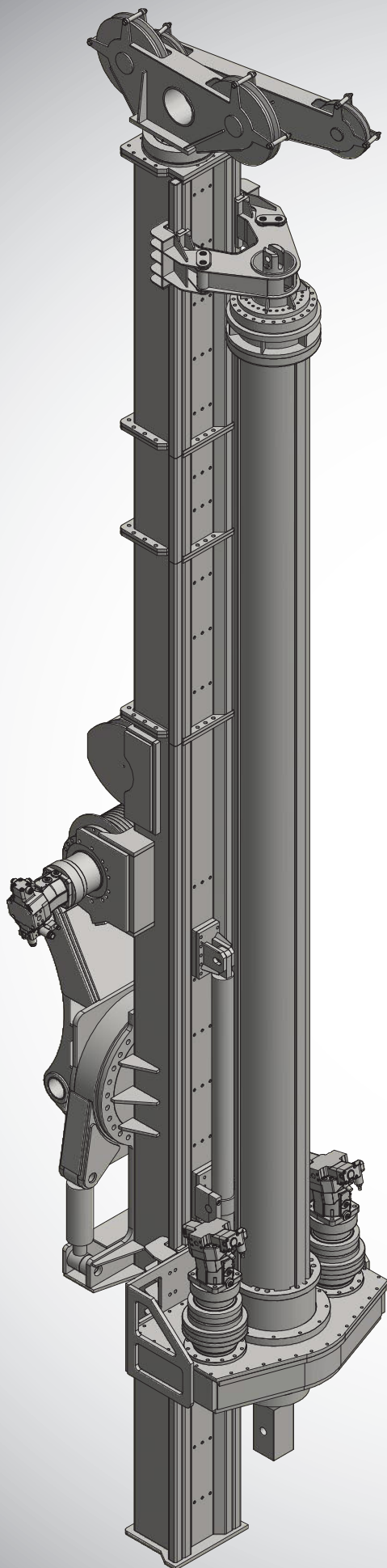

**SLD E300****ROTARY**

The Rotary has been designed in order to guarantee a very compact and powerful. SOIL TEK has developed a rotary with a two transmission group. Each transmission group is made up of a hydraulic motor and a reducer purposely studied and designed to obtain maximum performance. Also the pinion are supported by two bearings.

MAST

The mast structure is built with DOMEX 690 steel material, complete with the outer control pull-down cylinder with stroke of 47 Inches for pull on Kelly bar. Kelly is mounted outside the mast and complete with rope swivel. Rotary and mast assemblies are mounted on a rotating hinge complete with two cylinder for leveling position.

Therefore, the mast is **MODULAR** complete with a base mast, where is possible to apply number one or two extensions, permit to work in restricted spaces.

KELLY BAR

Telescoping multi-element.
Kelly stub 130mm

MAIN WINCH

"Controlled freefall" drive by Rex-Roth hydraulic motor

SERVICE WINCH

#7,000 Lbs. Line Pull

CONTROLS

By joystick pilot operated control valves located in the cab.
The operator has excellent visibility and control of all drilling functions.

BASE**EXCAVATOR**

Volvo EC300EL

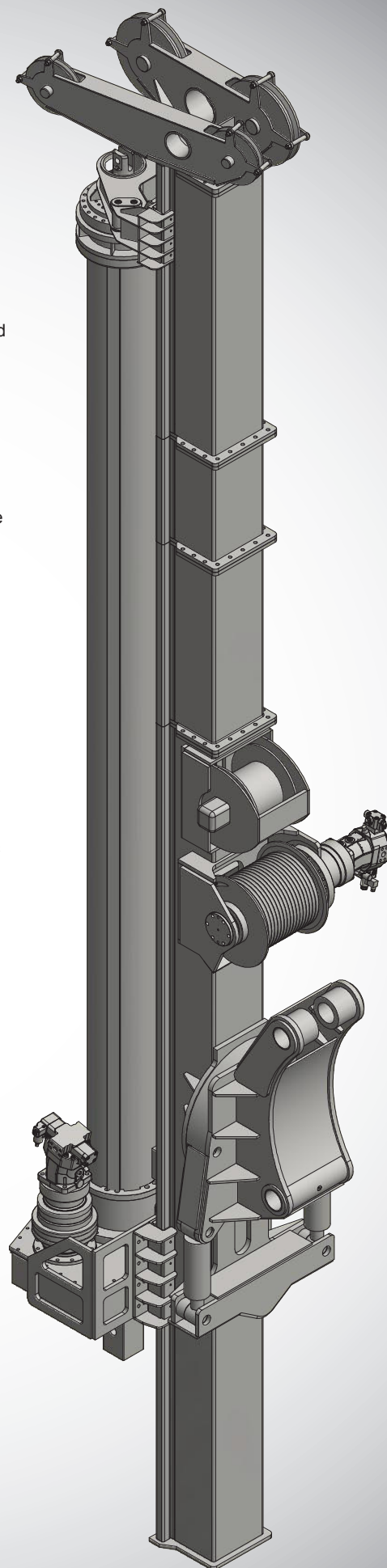

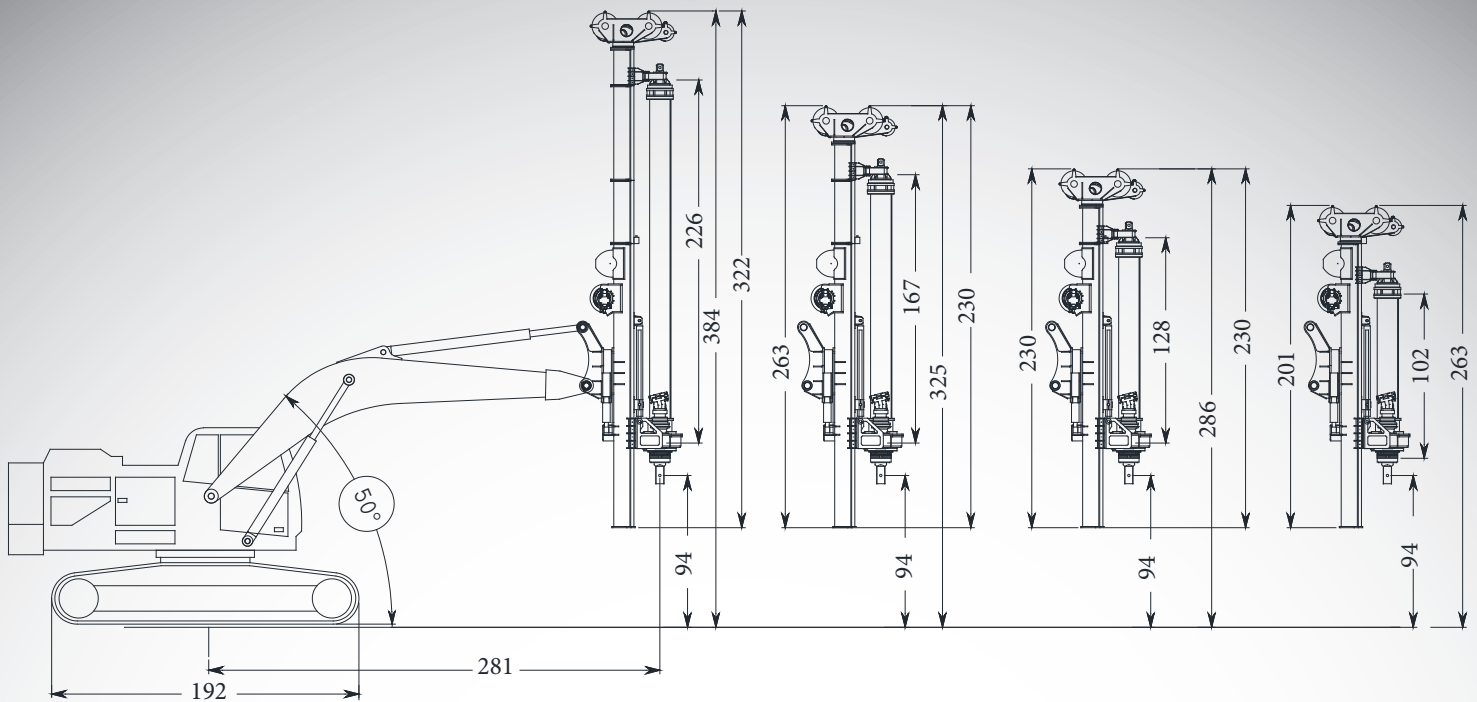

Main Winch

Nominal line-pull	Lbs.	SOIL TEK	18,209 Lbs.
Effective line-pull	Lbs.		15,062 Lbs.
Rope	dia/mm		18
Max line speed	Ft/min		177
Hydraulic release			Included

Service winch

Nominal line pull	Lbs.	7,868
Rope	dia/mm	14

Pull - Down

Max line pull	Lbs.	17,984 Lbs.
Max crowd	Lbs.	15,736 Lbs.
Stroke	Inches	47"

PILING Kelly-bar

dia / Inches	15" - 70"
dia / Inches	12.71

Mast H=Inches	Kelly-bar	Drilling depth = Feet
322	5x226	82'
263	5x167	59'
230	5x127	42'
200	5x102	31'

NOTE At the drilling depth to summarize the length of tool
Data referred as from the drawing above mast configuration

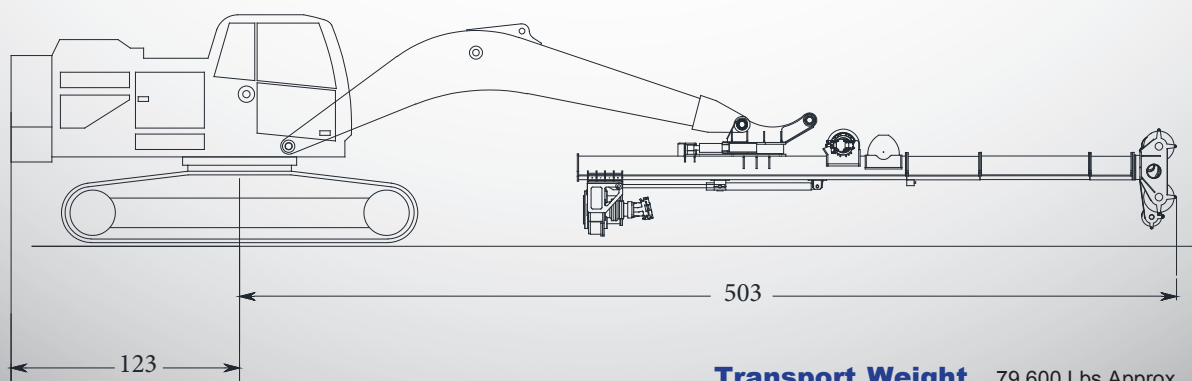

Transport Weight 79,600 Lbs.Approx.

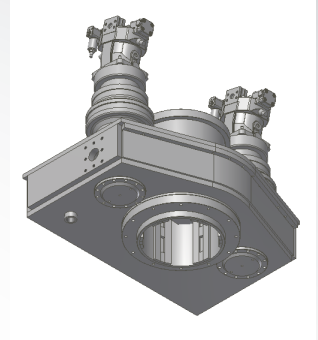
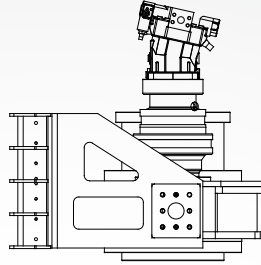
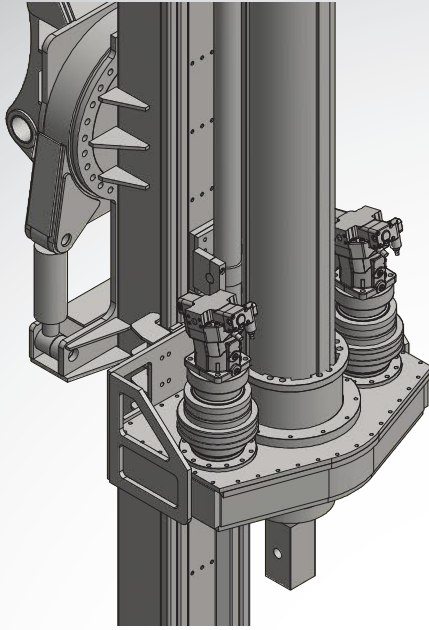

Rotary

Nominal torque	Ft. Lbs.	RTLD 5 43,737
1 [^] speed		
Torque	Ft. Lbs.	37,541 @4,351PSI
Drilling speed	rpm	25 - 50
2 [^] speed		
Torque	Ft. Lbs.	30,313 @ 4,351 PSI
Drilling speed	rpm	30- 60
Spin-off speed	rpm	80

Rotary

Nominal torque	Ft. Lbs.	RTLD 6 49,711
1 [^] speed		
Torque	Ft. Lbs.	42,631 @ 4,351 PSI
Drilling speed	rpm	20 - 40
2 [^] speed		
Torque	Ft. Lbs.	31,899 @ 4,351 PSI
Drilling speed	rpm	25 - 50
Spin-off speed	rpm	80

Rotary

Nominal torque	Ft. Lbs.	RTLD7 58,562
1 [^] speed		
Torque	Ft. Lbs.	50,154 @4,351 PSI
Drilling speed	rpm	15 - 30
2 [^] speed		
Torque	Ft. Lbs.	36,878 @ 4351 PSI
Drilling speed	rpm	20 - 40
Spin-off speed	rpm	75





Tipo: Sollecitazione di Von Mises
Unità: MPa
12/01/2017, 14:29:40

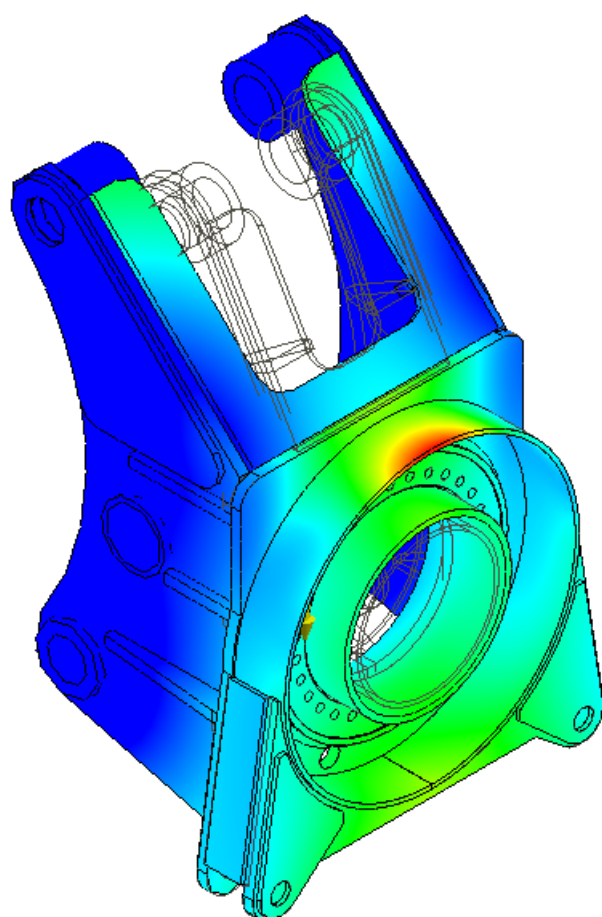
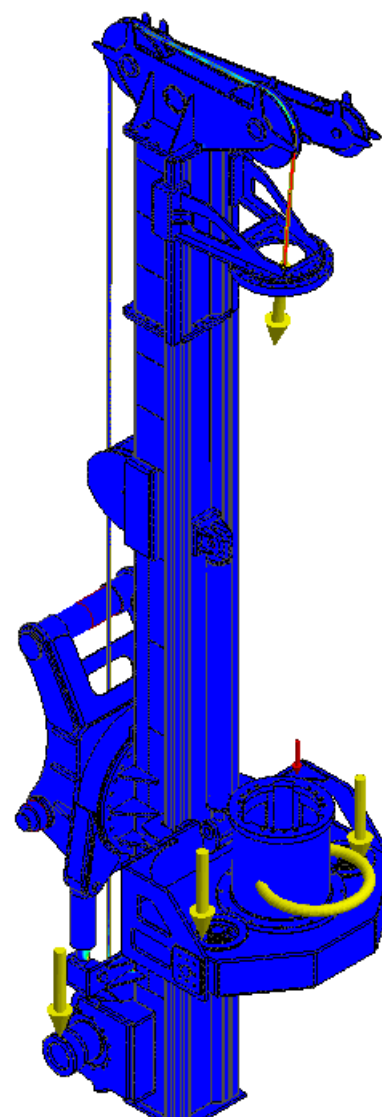
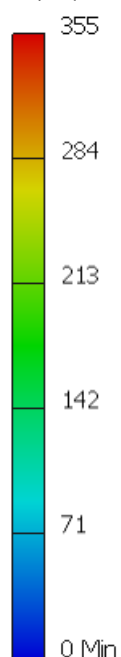

Tipo: Spostamento
Unità: mm
12/01/2017, 15:59:52
0,0249 Max

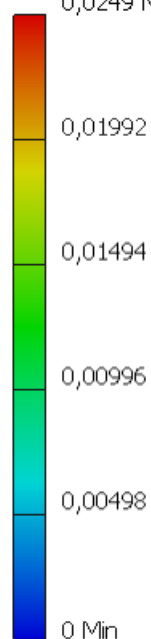



Jinnings Equipment



SOIL TEK 

SOIL TEK SRL via Don Morosini s.n. 66010 Tollo (CH) Italy
tel. ++39 0871 969110
www.soiltek.it - mail: info@soiltek.it